

SUSPENSION CLAMP BOLTED TYPE

AI 075

1. Make sure the clamp matches the conductor. Loosen the bolts and remove the straps.

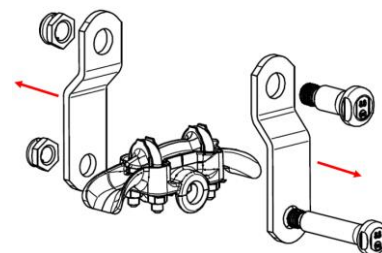

2. Take off all nuts and safety plate from the U-Bolt.

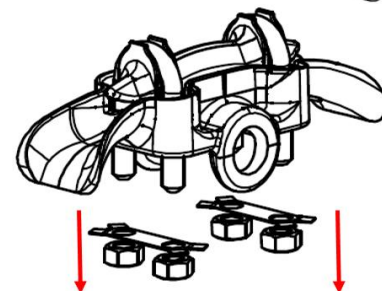

3. Remove the cover piece with the U-Bolt and mount the clamp body in the correct position under the conductor.

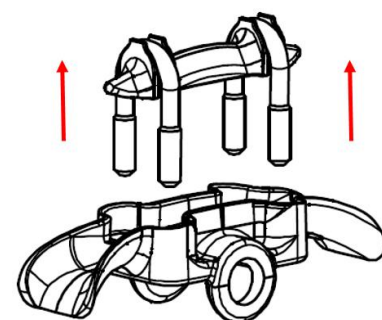

4. Assemble the cover piece and the U- Bolt with the clamping body. Tighten the four nuts evenly by hand. The clamping body and the cover piece must be parallel before starting tightening.

5. Start tightening the nuts with a calibrated torque wrench to 10 Nm, by rotating continuously from nut to nut. Ensure that the clamping body and the cover piece remain parallel throughout the assembly. When the 10 Nm is reached on all four nuts, than the tightening torque can be increased in 10 Nm increments according to the installation torque on the drawing.

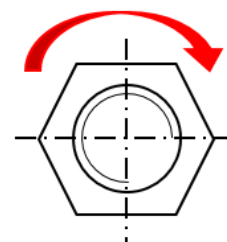

6. After tightening of all four nuts, bend the safety plate with a screwdriver and check that all four nuts are properly locked. Install the straps and make sure, that you assemble the bolts according to AI024.

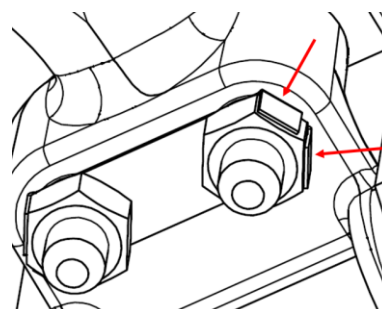

REV.	-	26-07-2011 / PAO
	A	08.04.2024 / EUS

LANGUAGE

EN

PAGE

1 of 1